

URPV

Fuses for PV Semiconductor Protection

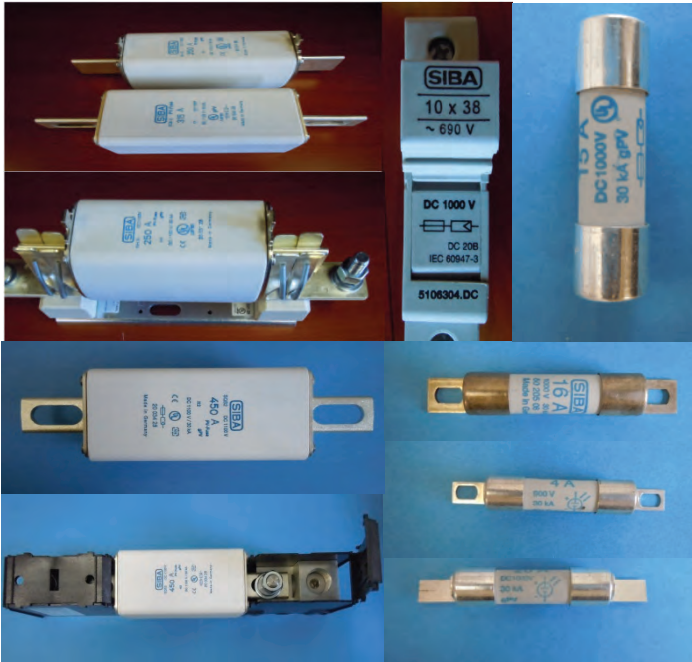

**Class:** gPV

**Voltage ratings:** 600V<sub>DC</sub> to 1500V<sub>DC</sub>



**Current ratings:** 1 A to 450 A

**Standards:** UL 2579  
IEC 60 269-6

**Approvals:** E341342   
E341490



Features and Benefits

-  High interrupting ratings up to 30kA
-  Low  $I^2t$  values
-  Fuse accessories available - Microswitches, Fuse Bases,

URPV  
UL 2579

## Fuses for PV Semiconductor Protection &amp; Accessories

Article	Description	Selection Guide	Technical Data
<b>600V<sub>DC</sub></b>			
2018928	NH00, DIN 80	No blown fuse indication	502
2018929		With blown fuse indication	
2041229		With fitting for microswitch	
<b>1000V<sub>DC</sub></b>			
5021528	10x38mm	No blown fuse indication	504
5021628	10x38mm - PCB Mount		
5021728	10x38mm - 50.6mm mounting centers		
5021828	10x38mm - For cable connection		
<b>1100V<sub>DC</sub></b>			
5023528	14x65mm	No blown fuse indication	506
5023728	14x65mm - 77.5mm mounting centers		
5023828	10/14x85mm clip mounting		
5023928	14x65mm for cable connection		
2002828	NH1XL	No blown fuse indication	508
2002829		With fitting for microswitch	
2003328	SQB1 - US Short	509	
2002929	NH2XL		
2002929	SQB2 - US Short		
2001828	SQB0 - M8		
2001928	SQB1 - M8		
2002028	SQB2 - M10		
2002128	SQB3 - M12		
2003128	NH3L	No blown fuse indication	510
2003129		With fitting for microswitch	
2003428	SQB2 - US Long	No blown fuse indication	510 - 511
2003429		With fitting for microswitch	
<b>1500V<sub>DC</sub></b>			
2004728	SQB3 - US Short	No blown fuse indication	512
2004528	NH1XL - Knife blade	No blown fuse indication	
2004129	NH1XL - SQB1- US Short	With fitting for microswitch	
2004229	NH2XL - Knife blade	With fitting for microswitch	
2004328	NH3L - Knife blade	With fitting for microswitch	
2004428	SQB0 - US Short	No blown fuse indication	
2004628	SQB2 - US Short	No blown fuse indication	
2003628	SQB3 - US Short	No blown fuse indication	
5024028	14mmx65mm	No blown fuse indication	513
<b>Accessories - Fuse Modules</b>			
5106305.1DC	10mmx38mm 1-Pole, 1000V <sub>DC</sub>	No blown fuse indication	504
5106305.1LDC		w/ Neon Lamp Indicator	
5106305.2DC	10mmx38mm 2-Pole, 1000V <sub>DC</sub>	No blown fuse indication	
5106305.2LDC		w/ Neon Lamp Indicator	
<b>Accessories - Fuse Base</b>			
2118928	Fuse Base NH00 DIN80	For use with microswitch	513
2119028	Fuse Base NH00 DIN80	With terminal covers	
2102828	Fuse Base NH1XL		508
2103128	Fuse Base NH3L		510
PV1 Fuse Base	35A-200A, 3/0-10 CU9AI		512
PV2 Fuse Base	200A-450A, 600kcmil -4/0CU9AICU9AI		
PV3 Fuse Base	200A-450A, 2x250kcmil -6CU9AI		
PV4 Fuse Base	200A-450A, 2x250kcmil -6CU9AI		
5123805	Fuse base for 50 238 28		507

## SIBA LLC

29 Fairfield Place  
West Caldwell, New Jersey 07006e-mail: info@sibafuse.com  
www.siba-fuses.us

URPV UL 2579		Fuse Accessories	
Accessories - Microswitch			
2800201	Microswitch		514
2800202			
Accessories - Fuse Clips			
5806316	10mm, PCB mounting		514
5806319	10mm, PCB mounting		
5806317	10mm, screw mounting		515
6301701	Clamping plate for 58 063 17		
6101701.3	Terminal link for 58 063 17		
6100101.2	14mm, screw mounting		515
6301701	Clamping plate for 60 001 01.2		
Fuse Clips			
5805806	14mm, PCB mounting		515
Grip Handle - Fuse Insertion-Removal Tool			
2200102	NH00 -3, 690V <sub>AC</sub>	Standard	516
2200105		w/Leather Sleeve	
2212001	NH4a & NH4, 690V <sub>AC</sub>	w/Leather Sleeve	
2203101	NH3, 1600V <sub>AC</sub>	Standard	
2203102	NH3, 1600V <sub>AC</sub>	w/Leather Sleeve	

<b>URPV</b>	<b>Rated Voltage</b>	<b>Rated Breaking Test</b>	<b>Class</b>	<b>Standard(s)</b>
	[Un] 600V <sub>DC</sub>	Capacity 30kA (L/R=1 - 3ms)	gPV 600V <sub>DC</sub> (UL)	UL 2579 IEC 60 269-2
E341342				

**Size NH00 - DIN 80**

Rated Current I <sub>n</sub> [A]	Without indicator		With Top Indicator		With Top Indicator and Fitting for Microswitch		Power Loss [W]	Pre-arcing I <sup>2</sup> t [A <sup>2</sup> s]	Total I <sup>2</sup> t* @600V <sub>DC</sub> [A <sup>2</sup> s]	
	Article Number	UL	Article Number	UL	Article Number	UL				
35	2018928.35	✓	2018929.35	✓	2041229.35	✓	7.3	62	380	
40	2018928.40	✓	2018929.40	✓	2041229.40	✓	7.5	105	630	
50	2018928.50	✓	2018929.50	✓	2041229.50	✓	11.0	160	960	
63	2018928.63	✓	2018929.63	✓	2041229.63	✓	12.5	250	1 500	
70	2018928.70	✓	2018929.70	✓	2041229.70	✓	13.0	415	2 500	
80	2018928.80	✓	2018929.80	✓	2041229.80	✓	14.0	520	3 200	
100	2018928.100	✓	2018929.100	✓	2041229.100	✓	15.5	1 000	6 000	
110	2018928.110	✓	2018929.110	✓	2041229.110	✓	17.5	1 300	7 900	
125	2018928.125	✓	2018929.125	✓	2041229.125	✓	20.0	1 650	10 000	
160	2018928.160	✓	2018929.160	✓	2041229.160	✓	21.5	4 000	24 000	
Weight [kg / 1]										
0.78										
Units per Package										
1										
<b>IEC Part Numbers</b>				<b>IEC - Contact SIBA for Data Sheets</b>						
			2018926.(Amp)		2041226.(Amp)					

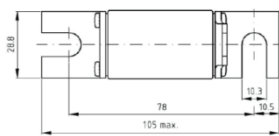
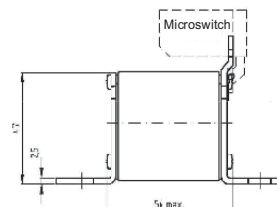
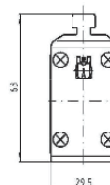
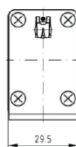
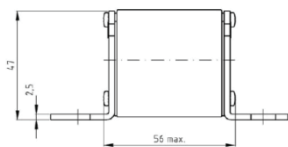

2018928 / 2018929

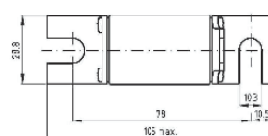

2041229

**Accessories**

Article Number	Fuse Base	Page	Article Number	Microswitch - GL	Page
2119028	80mm center, w/insulated covers	513	2800201	Standard (Black Hammer)	514
2118928	80mm center, use w/microswitch				

URPV	Rated Voltage [Un]	Rated Breaking Test Capacity	Class gPV	Standard(s)
 E341342	1100V <sub>DC</sub>	30kA (L/R=1 - 3ms)	1100V <sub>DC</sub> (UL)	UL 2579 IEC 60 269-2
Size NH00 - DIN 80				

Coefficients for Heavy Duty Applications				
a	A2	B1	B2	Cf3
130	0.8	1.25	0.5	0.8

**Time-Current Characteristics**

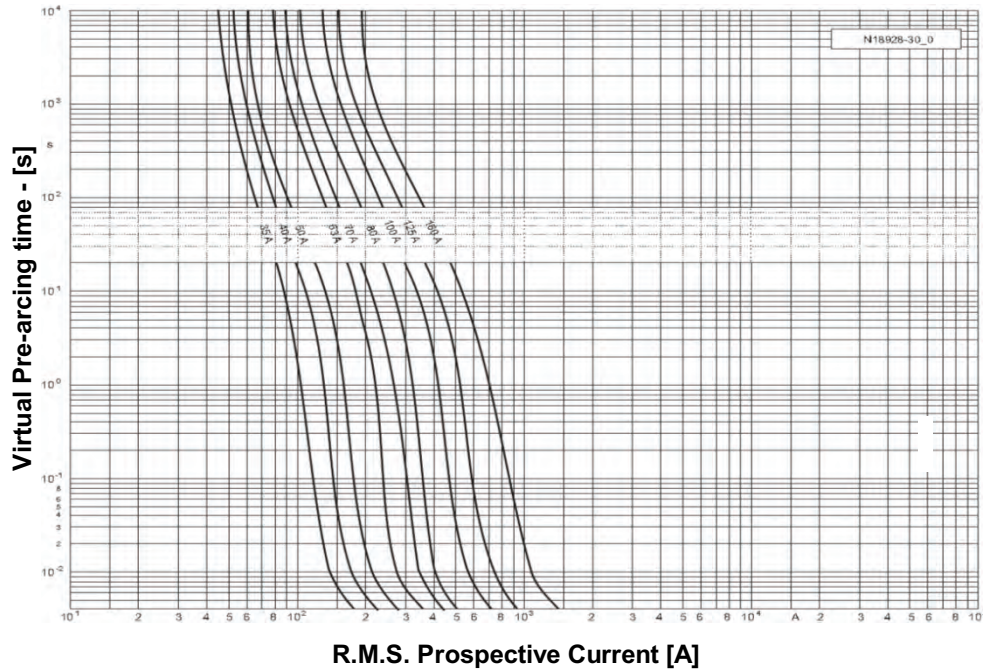

<b>URPV</b>	<b>Rated Voltage</b> [Un]	<b>Rated Breaking Test</b> Capacity	<b>Class</b> gPV	<b>Standard(s)</b>
E341342	1000V <sub>DC</sub>	30kA (L/R=1 - 3ms)	1000V <sub>DC</sub> (UL) 1000V <sub>DC</sub> (IEC)	UL 2579 IEC 60 269-6

**Size 10x38mm**

Rated Current I <sub>n</sub> [A]	Without indicator		Without indicator PCB		Without indicator 50.6mm Mounting		Without indicator Offset Tabs for cable attachment		Power Loss [W]	Pre-arcing I <sup>2</sup> t [A <sup>2</sup> s]	Total I <sup>2</sup> t* @1000V <sub>DC</sub> [A <sup>2</sup> s]
	Article Number	UL	Article Number	UL	Article Number	UL	Article Number	UL			
3.5	5021528.3.5	✓	5021628.3.5	✓	5021728.3.5	✓	5021828.3.5	✓	1.5	8	
4	5021528.4	✓	5021628.4	✓	5021728.4	✓	5021828.4	✓	1.8	10	
5	5021528.5	✓	5021628.5	✓	5021728.5	✓	5021828.5	✓	2	20	
8	5021528.8	✓	5021628.8	✓	5021728.8	✓	5021828.8	✓	1.9	3	
10	5021528.10	✓	5021628.10	✓	5021728.10	✓	5021828.10	✓	2.3	5	
12	5021528.12	✓	5021628.12	✓	5021728.12	✓	5021828.12	✓	2.9	9	
15	5021528.15	✓	5021628.15	✓	5021728.15	✓	5021828.15	✓	3.3	17	
16	5021528.16	✓	5021628.16	✓	5021728.16	✓	5021828.16	✓	3.4	20	
20	5021528.20	✓	5021628.20	✓	5021728.20	✓	5021828.20	✓	3.9	40	
22.4	5021528.22.4	✓	5021628.22.4	✓	5021728.22.4	✓	5021828.22.4	✓	4.5	52	

Power loss limit of fuse base has to be considered

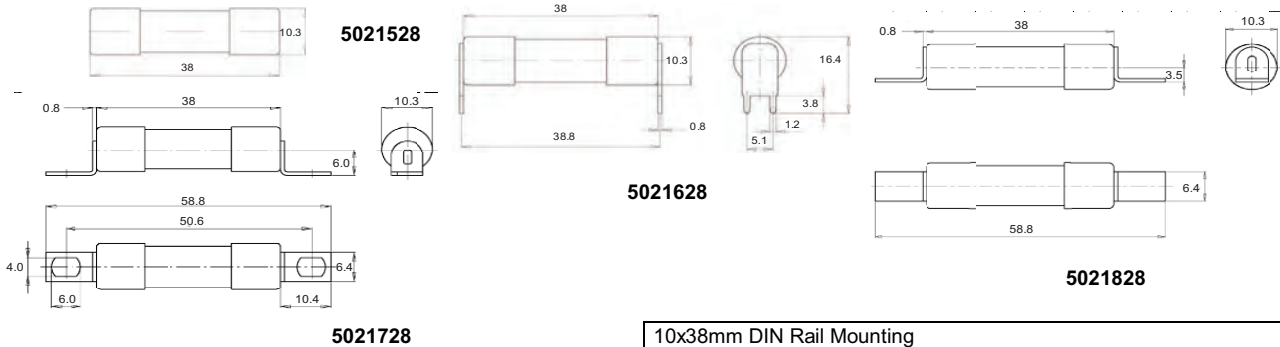

**5106305 DC Series for 10x38mm 1000V<sub>DC</sub> Fuse Links**

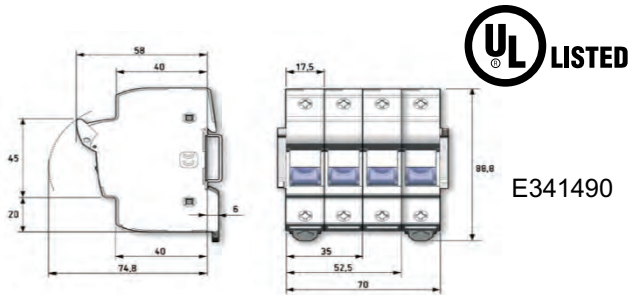

10x38mm DIN Rail Mounting
Rated voltage; IEC/UL 1000V <sub>DC</sub> / 690V <sub>AC</sub>
Rated current; 30A UL, 32A IEC
Power acceptance; 4W
Utilization category; AC - 21B 690V <sub>AC</sub> , DC - 20B 1000V <sub>DC</sub>
Rated insulating voltage; > 6kV
Contacts; copper-silver plated
Conductor; 0.75mm <sup>2</sup> - 16mm <sup>2</sup> solid wire or stranded wire
Maximum torque; 2.5N•m
Degree of protection; IP-20 ( cable size < 6mm <sup>2</sup> contact SIBA)
Construction, body & handle; Thermoplastic Polyester
Flammability "UL 94"; V0
Rating of indicator; 350V <sub>DC</sub> - 1000V <sub>DC</sub>
Storage & Operating temperature range; -50°C to +85°C**
* Operating temperature depends upon connections and mounting parts
** Avoid handling of lever during installation or maintenance below -20°C
<b>Important: DO NOT OPEN UNDER LOAD !</b>

	Article No.	
1-Pole	5106305.1DC	5106305.1LDC
2-Pole	5106305.2DC	5106305.2LDC

**Accessories**

Article Number	Fuse Clips 10mm	Page	Article Number	Page
5806316	PCB	514 - 515		
5806319	PCB			
5806317	Screw Mounting			

<b>URPV</b>	<b>Rated Voltage</b> [Un]	<b>Rated Breaking Test</b> Capacity	<b>Class</b> gPV	<b>Standard(s)</b>
 E341342	1000V <sub>DC</sub>	30kA (L/R=1ms)	1000V <sub>DC</sub> (UL)	UL 2579 IEC 60 269-2
<b>Size 10x38mm</b>				

Coefficients for Heavy Duty Applications				
a	A2	B1	B2	Cf3
130	0.8	1.25	0.5	0.8

**Time-Current Characteristics**

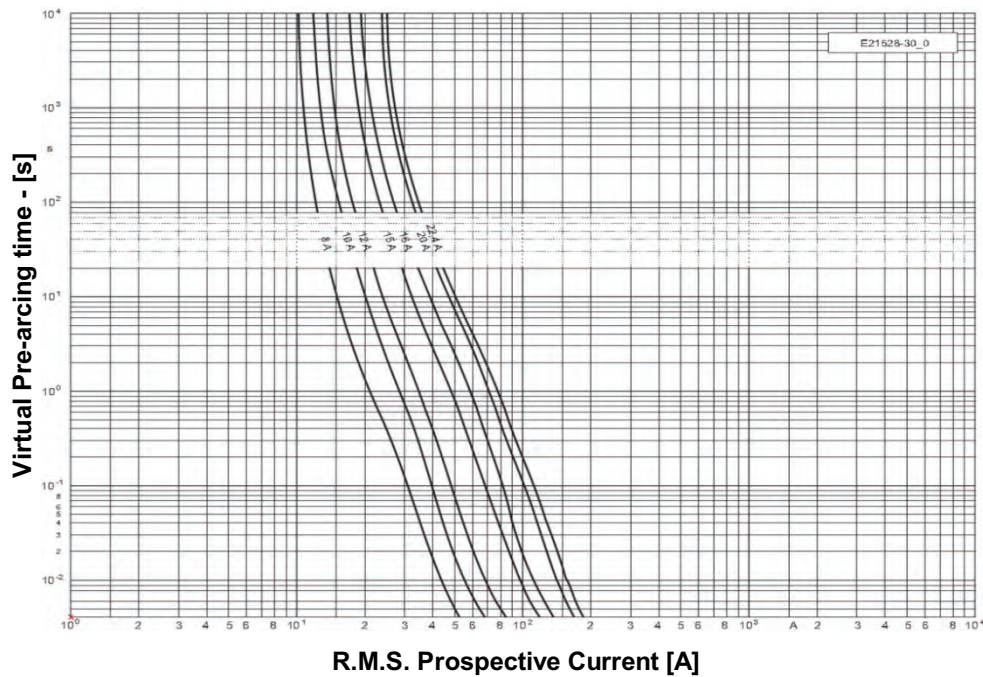

<b>URPV</b>	<b>Rated Voltage</b> [Un]	<b>Rated Breaking Test</b> Capacity	<b>Class</b> gPV	<b>Standard(s)</b>
 E341342	1000V <sub>DC</sub>	30kA (L/R=1 - 3ms)	1000V <sub>DC</sub> (UL) 1000V <sub>DC</sub> (IEC)	UL 2579 IEC 60 269-6
<b>Size 14x51mm</b>				

**New Contact SIBA**



<b>URPV</b>	<b>Rated Voltage</b> [Un]	<b>Rated Breaking Test</b> Capacity	<b>Class</b> gPV	<b>Standard(s)</b>
 E341342	1000V <sub>DC</sub>	30kA (L/R=1 - 3ms)	1000V <sub>DC</sub> (UL) 1000V <sub>DC</sub> (IEC)	UL 2579 IEC 60 269-6
<b>Size 22x58mm</b>				



**New Contact SIBA**

<b>URPV</b>	<b>Rated Voltage</b>	<b>Rated Breaking Test</b>	<b>Class</b>	<b>Standard(s)</b>
	[Un]	Capacity	gPV	UL 2579
E341342	1100V <sub>DC</sub>	30kA (L/R=1ms)	1100V <sub>DC</sub> (UL)	IEC 60 269-6

**Size 14x65/85mm**

Rated Current I <sub>n</sub> [A]	Without indicator		Without indicator 77.5mm Mounting		Without indicator 10/14mm Clip Mount		Without indicator w/Offset Tabs		Power Loss [W]	Pre-arcing I <sup>2</sup> t [A <sup>2</sup> s]	Total I <sup>2</sup> t* @1100V <sub>DC</sub> [A <sup>2</sup> s]
	Article Number	UL	Article Number	UL	Article Number	UL	Article Number	UL			
10	5023528.10	✓	5023728.10	✓	5023828.10		5023928.10	✓	4.0	3	21
12	5023528.12	✓	5023728.12	✓	5023828.12		5023928.12	✓	4.1	7.5	51
16	5023528.16	✓	5023728.16	✓	5023828.16		5023928.16	✓	4.6	16	109
20	5023528.20	✓	5023728.20	✓	5023828.20		5023928.20	✓	5.5	30	205
25	5023528.25	✓	5023728.25	✓	5023828.25		5023928.25	✓	5.9	82	560
<b>Weight [kg / 1]</b>											
0.78											
<b>Units per Package</b>											
1                      1                      1                      1											
<b>IEC Part Numbers</b>						<b>IEC - Contact SIBA for Data Sheets</b>					
5023526.(Amp)			5023726.(Amp)			5023826.(Amp)			5023926.(Amp)		

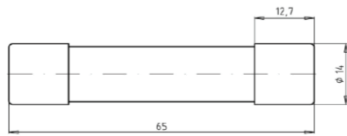

5023528

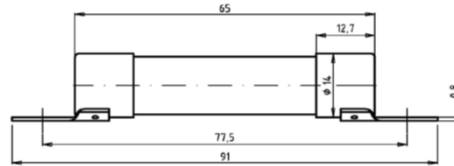

5023728

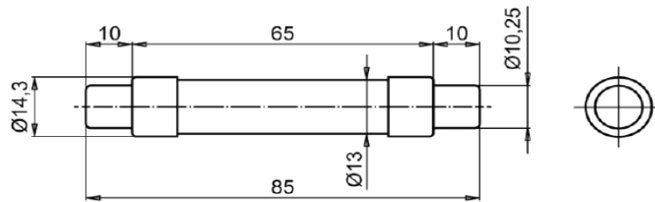

5023828



5023928

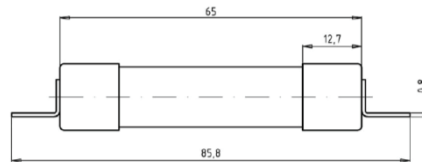

**Accessories**

Article Number	Fuse Clips 10mm	Page	Article Number	Fuse Clips 14mm	Page
5806316	PCB	514	6100101.2	Screw Mounting	515
5806319	PCB		5805806	PCB	
5806317	Screw Mounting	515	5123805	Fuse Base	507



URPV	Rated Voltage [Un]	Rated Breaking Test Capacity	Class gPV	Standard(s)
 E341342	1100V <sub>DC</sub>	30kA (L/R=1ms)	1100V <sub>DC</sub> (UL)	UL 2579 IEC 60 269-6
Size 14x65/85mm				

Coefficients for Heavy Duty Applications				
a	A2	B1	B2	Cf3
130	0.8	1.25	0.5	0.8

**Time-Current Characteristics**

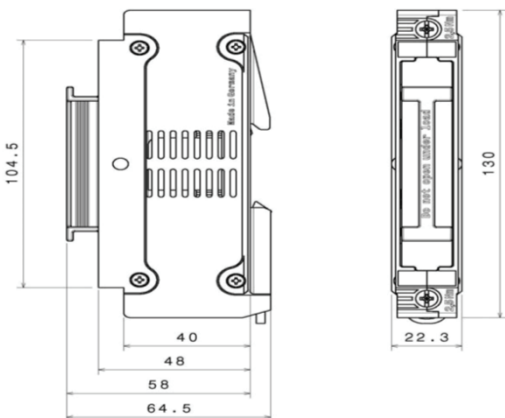
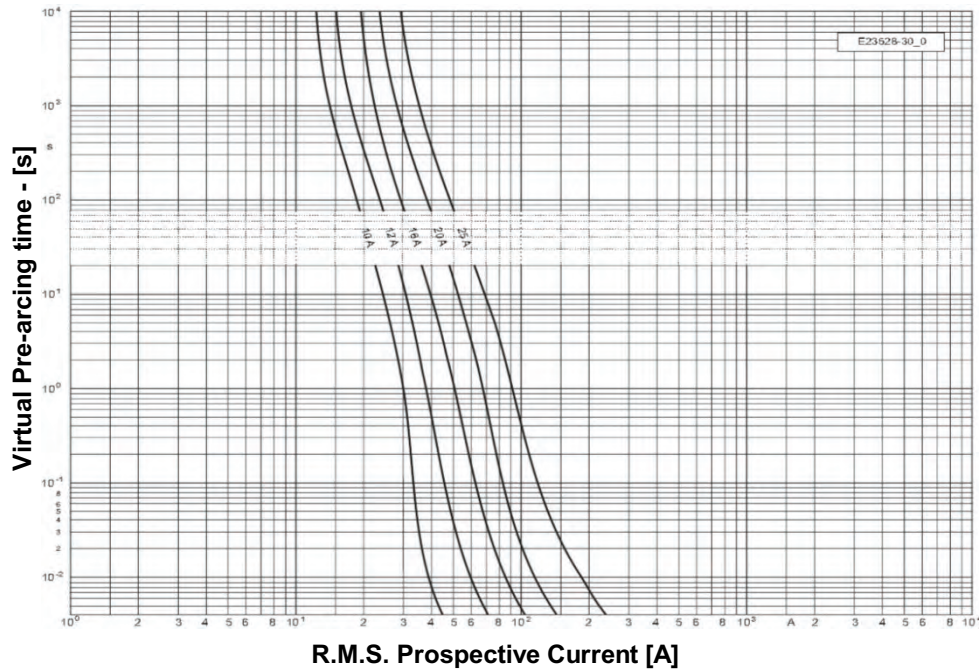

5123805  
For 5023828 Fuse

DIN Rail Mounting
Rated voltage; 1500V <sub>DC</sub> , 1000V <sub>AC</sub>
Rated current; 32A
Power acceptance; 6W
Conductor; 0.7mm <sup>2</sup> - 25mm <sup>2</sup> (maximum)
Insulating voltage(between fuse contacts & DIN rail); -
Rated impulse current; -
Construction, body & handle; -
Degree of protection; -
Maximum torque; 2.5N•m
Contacts; -
Flammability -
Operating temperature range; -
Important: DO NOT OPEN UNDER LOAD !

<b>URPV</b>	<b>Rated Voltage</b>	<b>Rated Breaking Test</b>	<b>Class</b>	<b>Standard(s)</b>
	[Un]	Capacity	gPV	UL 2579
E341342	1100V <sub>DC</sub>	30kA (L/R=1 - 3ms)	1100V <sub>DC</sub> (UL)	IEC 60 269-6

**Size NH1XL**

Rated Current I <sub>n</sub> [A]	Without indicator		With Top Indicator and Fitting for Microswitch		Power Loss [W]	Pre-arcing I <sup>2</sup> t [A <sup>2</sup> s]	Total I <sup>2</sup> t* @1100V <sub>DC</sub> [A <sup>2</sup> s]
	Article Number	UL	Article Number	UL			
50	2002828.50	✓	2002829.50	✓	17	270	900
63	2002828.63	✓	2002829.63	✓	20	600	2 000
80	2002828.80	✓	2002829.80	✓	23	1 100	4 000
100	2002828.100	✓	2002829.100	✓	27	1 900	6 500
125	2002828.125	✓	2002829.125	✓	32	3 600	12 000
150	2002828.150	✓	2002829.150	✓	34	6 700	22 000
160	2002828.160	✓	2002829.160	✓	36	7 600	25 000
175	2002828.175	✓	2002829.175	✓	37	9 600	31 500
200	2002828.200	✓	2002829.200	✓	43	14 300	47 000

Weight [kg / 1]		
0.78		
Units per Package		
1		

IEC Part Numbers ( Not UL)		IEC - Contact SIBA for Data Sheets
2002921.(Amp)	2002920.(Amp)	Fuse Base 2102801

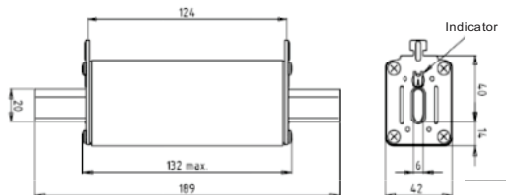

2002828 / 2002829

Fuse Size	Fuse Base	Rated Voltage	Rated Current	Breaking Capacity	Rated Power Acceptance	Weight	Units per Package	External Wall	Partition Wall	Insulating Contact Covers
NH1XL	Article No.	[V <sub>DC</sub> ]	[A]	[kA]	[W]	[kg/1]		Article No.	Article No.	Article No.
1 - Pole	2102828	1100	200	30	32	0.84	1	2500501	—	2100301.26



E341490

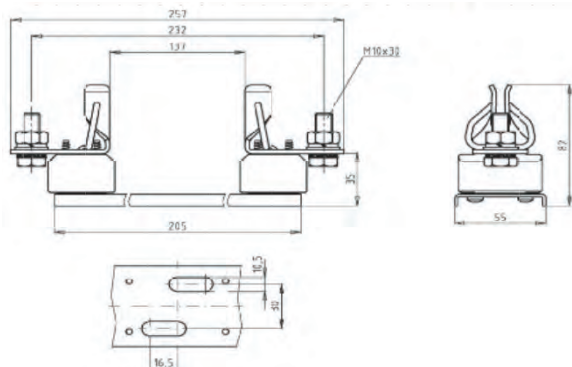

2102828



**SIBA LLC**

Phone 1-973-575-7422  
Fax 1-973-575-5858

29 Fairfield Place  
West Caldwell, New Jersey 07006

e-mail: info@sibafuse.com  
www.siba-fuses.us



FUSES

	URPV	Rated Voltage [Un]	Rated Breaking Test Capacity	Class gPV	Standard(s)
	E341342	1100V <sub>DC</sub>	30kA (L/R=1 - 3ms)	1100V <sub>DC</sub> (UL)	UL 2579 IEC 60 269-2
Size NH1XL					

Coefficients for Heavy Duty Applications				
a	A2	B1	B2	Cf3
130	0.8	1.25	0.5	0.8

**Time-Current Characteristics**

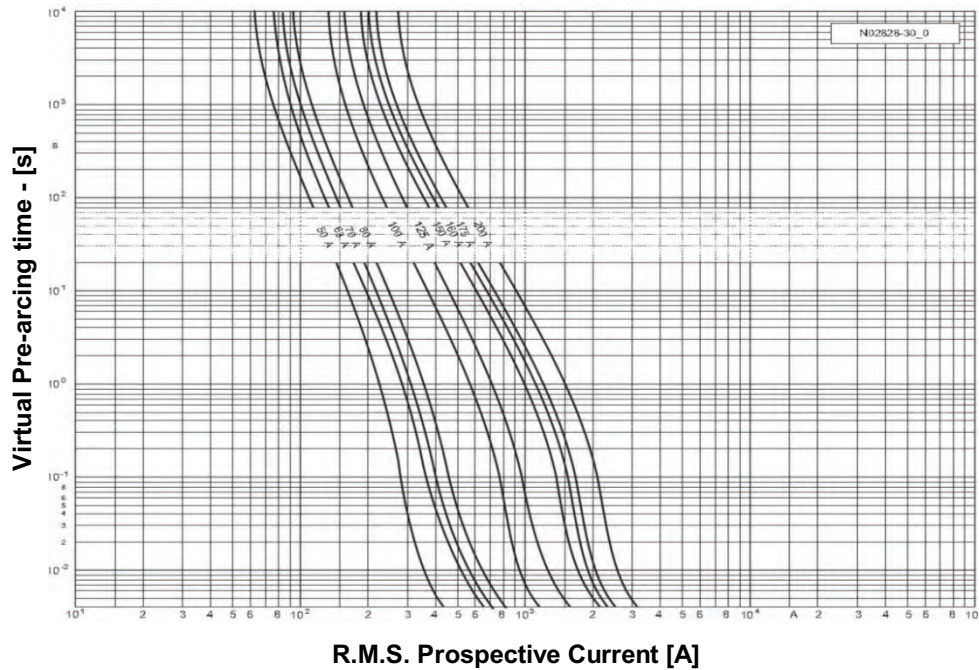

**Accessories**

Article Number	Grip Handle, Insertion/Removal Tool	Page	2800202	Article Number	Microswitch - GL	Page
2203101	Standard	511	2800202		Standard (Red Hammer)	509
2203102	w/Leather Sleeve					

	URPV	Rated Voltage [Un]	Rated Breaking Test Capacity	Class gPV	Standard(s)
	E341342	1100V <sub>DC</sub>	30kA (L/R=1 - 3ms)	1100V <sub>DC</sub> (UL)	UL 2579 IEC 60 269-2
Size NH2XL, SQB1, 2 & 3					
<b>New Product - Contact SIBA</b>					

Rated Current I <sub>n</sub> [A]	SQB1 US Short Article No 2003328	NH2XL Knife Blade Article No 2002929	SQB2 US Short Article No 2002929	SQB0 M8 Article No 2001828	SQB1 M8 Article No 2001928	SQB2 M10 Article No 2002028	SQB3 M12 Article No 2002128	Power Loss [W]	Pre-arcing I <sup>2</sup> t [A <sup>2</sup> s]	Total I <sup>2</sup> t* @1100V <sub>DC</sub> [A <sup>2</sup> s]
	to 250A	to 250A	to 450A	to 160A	to 250A	to 450A	to 500A			

<b>URPV</b>	<b>Rated Voltage</b> [Un]	<b>Rated Breaking Test</b> Capacity	<b>Class</b> gPV	<b>Standard(s)</b>
	E341342	1100V <sub>DC</sub>	30kA (L/R=1 - 3ms)	1100V <sub>DC</sub> (UL)
				UL 2579 IEC 60 269-6

**Size NH3L & SQB2**

Rated Current I <sub>n</sub> [A]	Without indicator		With Top Indicator and Fitting for Microswitch		Without indicator		With Top Indicator and Fitting for Microswitch		Power Loss [W]	Pre-arcing I <sup>2</sup> t [A <sup>2</sup> s]	Total I <sup>2</sup> t* @1100V <sub>DC</sub> [A <sup>2</sup> s]
	Article Number	UL	Article Number	UL	Article Number	UL	Article Number	UL			
	<b>NH3L</b>				<b>SQB2</b>				<b>NH3L</b>	<b>SQB2</b>	
200	2003128.200	✓	2003129.200	✓	2003428.200	✓	2003429.200	✓	42	39	13 000
250	2003128.250	✓	2003129.250	✓	2003428.250	✓	2003429.250	✓	48	42	26 500
315	2003128.315	✓	2003129.315	✓	2003428.315	✓	2003429.315	✓	65	59	38 000
350	2003128.350	✓	2003129.350	✓	2003428.350	✓	2003429.350	✓	64	62	57 000
400	2003128.400	✓	2003129.400	✓	2003428.400	✓	2003429.400	✓	71	77	80 000
450					2003428.450	✓	2003429.450	✓	-	87	92 500
500	Contact SIBA										
Weight [kg / 1]											
0.78											
Units per Package											
1											
IEC Part Numbers ( Not UL)						IEC - Contact SIBA for Data Sheets					
2003121.(Amp)		2003120.(Amp)		Fuse Base 2103101							

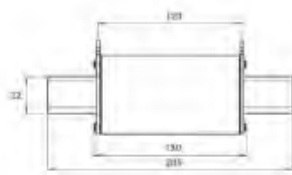

2003128 / 2003129

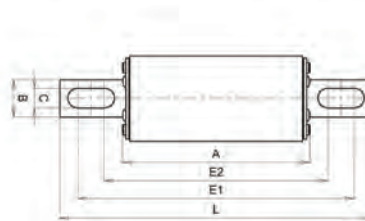
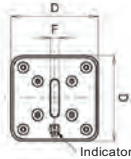
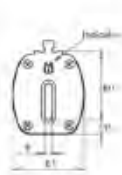

2003428 / 2003429

Dimensions in / mm	
A	5.08 / 129
B	1.02 / 26
C	0.55 / 14
D	2.36 / 60
E1	7.48 / 190
E2	6.06 / 154
F	0.24 / 6
L	8.46 / 215

Fuse Size	Fuse Base Article No.	Rated Voltage [V <sub>DC</sub> ]	Rated Current [A]	Breaking Capacity [kA]	Rated Power Acceptance [W]	Weight [kg/1]	Units per Package	External Wall Article No.	Partition Wall Article No.	Insulating Contact Covers Article No.
NH3L	2103128	1100	450	30	60	1.16	1	2500501	—	2100501.26

**Fuse Bases for SQB Series - 1500V<sub>DC</sub>**  
(UL 4248-18 - Pending)

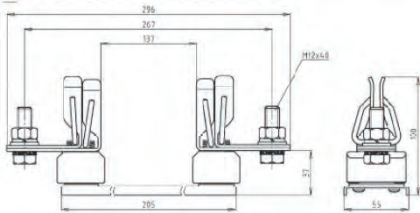

2103128



E341490

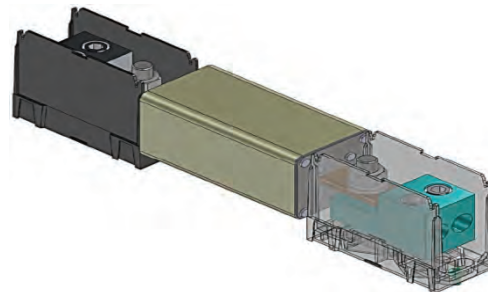

PV2 Fuse Base 3 (200A -450A, 600kcmil -4/0CU9Al)

	URPV	Rated Voltage	Rated Breaking Test	Class	Standard(s)
	E341342	[Un] 1100V <sub>DC</sub>	Capacity 30kA (L/R=1 - 3ms)	gPV Voltage 1100V <sub>DC</sub> (UL)	UL 2579 IEC 60 269-6
Size NH3L & SQB2					

Coefficients for Heavy Duty Applications				
a	A2	B1	B2	Cf3
130	0.8	1.25	0.5	0.8

**Time-Current Characteristics**

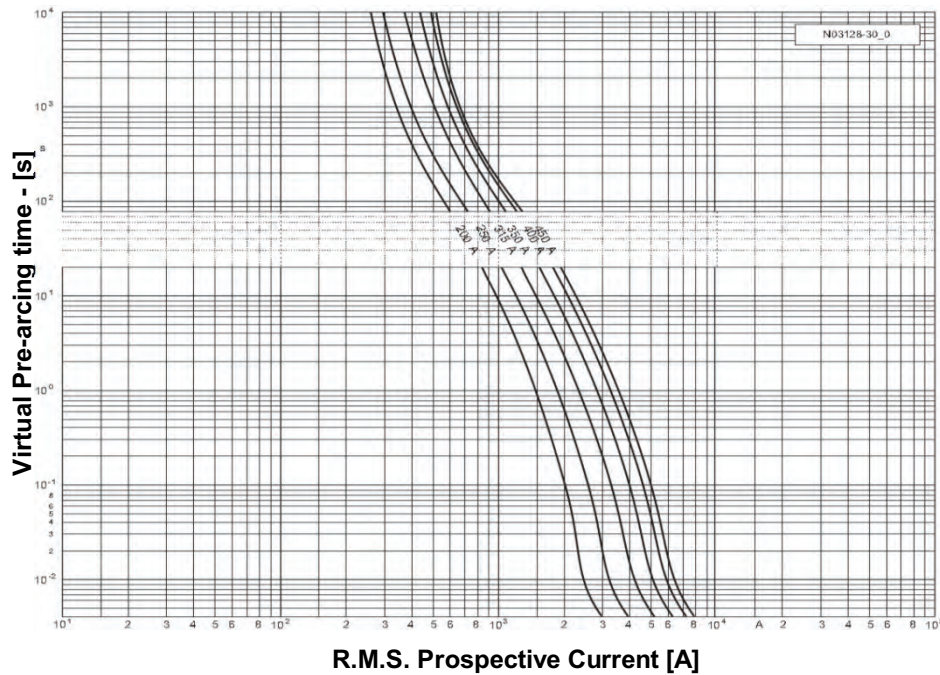

**Accessories**

Article Number	Grip Handle, Insertion/Removal Tool	Page	Article Number	Microswitch - GL	Page
2203101	Standard	516	2800202	Standard (Red Hammer)	514
2203102	w/Leather Sleeve				

<b>URPV</b>	<b>Rated Voltage</b>	<b>Rated Breaking Test</b>	<b>Class</b>	<b>Standard(s)</b>
	[Un]	Capacity	gPV	UL 2579
Pending	1500V <sub>DC</sub>	30kA (L/R=3ms)	1500V <sub>DC</sub> (UL)	IEC 60 269-6

**Size NH1&2XL, SQB0, 1, 2, & 3 New Product - Contact SIBA**

Rated Current I <sub>n</sub> [A]	SQB3	SQB1	NH1XL	NH2XL	NH3L	SQB0	SQB2	SQB3
	US Short Article No	US Short Article No	Knife Blade Article No	Knife Blade Article No	Knife Blade Article No	US Short Article No	US Short Article No	US Short Article No
	2004728	2004528	2004129	2004229	2004329	2004428	2004628	2003628
	to 355A	to 160A	to 200A	to 250A	to 250A	to 160A	to 250A	to 500A

Contact SIBA for Data Sheets

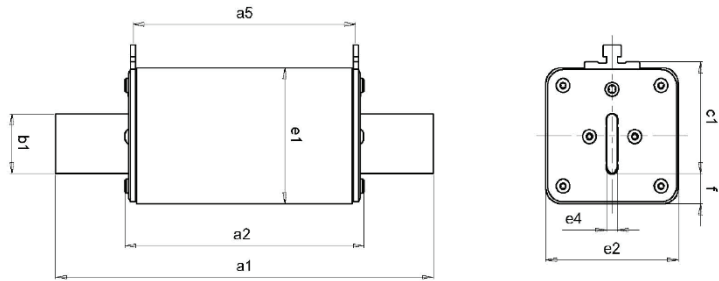

L- Series

SQB 0/1/2/3  
**Fuse Bases for SQB Series - 1500V<sub>DC</sub>**  
 (UL 4248-18 - Pending)

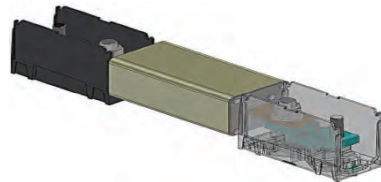

- PV1 Fuse Base (35 -200A, 3/0-10 CU9Al)
- PV2 Fuse Base (200A -450A, 600kcmil -4/0CU9Al)
- PV3 Fuse Base (200A -450A, 2x250kcmil -6CU9Al)
- PV4 Fuse Base (35A -450A, bus bar - 12mm stud)

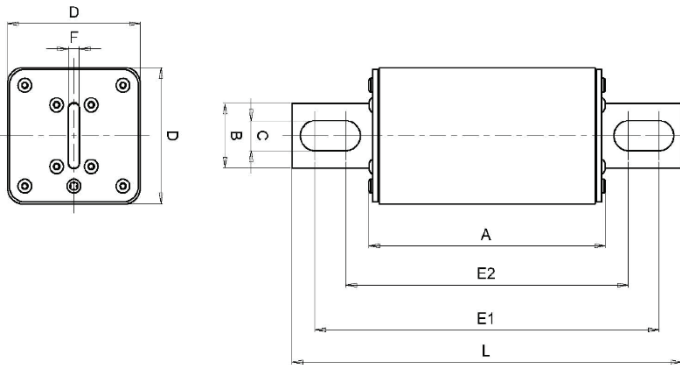

SQB - Series



E341490

**Accessories**

Grip Handle, Insertion/Removal Tool	Page	Article Number	Microswitch - GL	Page
Standard	516	2800202	Standard (Red Hammer)	514
w/Leather Sleeve				

<b>URPV</b>	<b>Rated Voltage</b> [Un] 1500V <sub>DC</sub>	<b>Rated Breaking Test</b> Capacity 30kA (L/R=3ms)	<b>Class</b> gPV	<b>Standard(s)</b> UL 2579 IEC 60 269-6
	Pending	1500V <sub>DC</sub>	1500V <sub>DC</sub> (UL)	
Rated Current I <sub>n</sub> [A]	14mmx65m Article No 5024028	<b>Contact SIBA for Data Sheets</b>		
	to 30A			

<b>URPV</b>	<b>E341490</b>	<b>Accessories</b> <b>Fuse Bases</b>								
		<b>Size NH00 - DIN80</b>								
Fuse Size	Fuse Base Article No.	Rated Voltage [V <sub>DC</sub> ]	Rated Current [A]	Breaking Capacity [kA]	Rated Power Acceptance [W]	Weight [kg/1]	Units per Package	External Wall Article No.	Partition Wall Article No.	Insulating Contact Covers Article No.
1 - Pole	2118928 2119028	600	160	30	34	0.25 0.26	5 3	—	—	Included N/A

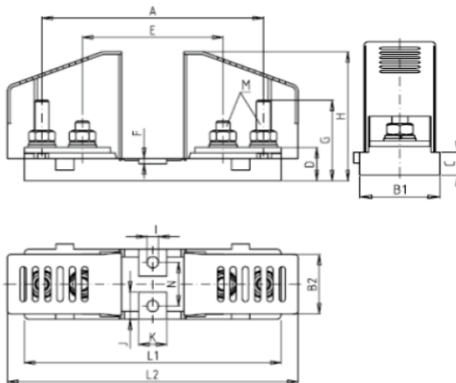
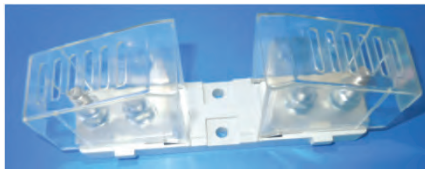

Dimensions [in / mm]		
2119028		2118928
4.96 / 126	<b>A</b>	4.96 / 126
—	<b>B</b>	1.57 / 40
1.57 / 40	<b>B<sub>1</sub></b>	—
1.34 / 34	<b>B<sub>2</sub></b>	—
0.50 / 13	<b>C</b>	0.50 / 13
0.75 / 19	<b>D</b>	0.75 / 19
3.15 / 80	<b>E</b>	3.15 / 80
0.12 / 3	<b>F</b>	0.12 / 3
1.81 / 46	<b>G</b>	1.81 / 46
—	<b>G<sub>1</sub></b>	—
—	<b>G<sub>2</sub></b>	—
2.91 / 74	<b>H</b>	4.40 / 112
0.26 / 6.5	<b>I</b>	0.26 / 6.5
0.60 / 15.5	<b>J</b>	0.60 / 15.5
0.63 / 16	<b>K</b>	0.63 / 16
—	<b>L<sub>max</sub></b>	5.75 / 146
5.75 / 146	<b>L<sub>1</sub></b>	—
6.50 / 165	<b>L<sub>2</sub></b>	—
M8	<b>M</b>	M8
0.98 / 25	<b>N</b>	0.98 / 25
Max M8 nut torque		
12N•m		
106lb•in		
Max base mounting torque		
4N•m		
35lb•in		

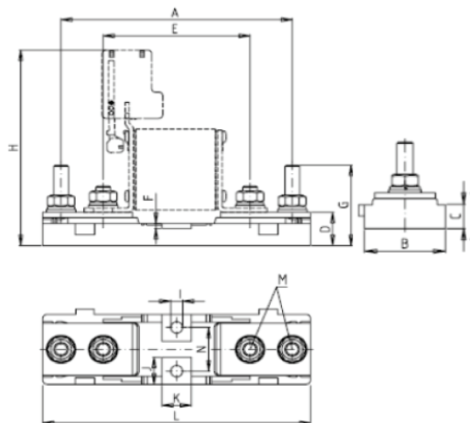

**URPV  
Accessories**

**Accessories  
Microswitches**

**GL Microswitch**

**Standard Level**

Article Number	Insulating Voltage [V]	Change Over Circuits	Interrupt Rating			
			AC		DC	
			[V]	[A]	[V]	[A]
2800201	—	1	250	5(resistive)	33	3(resistive)
2800202				3(inductive)	26	3(inductive L/R =10ms)
*						

Article Number	Insulating Voltage [V]	Change Over Circuits	Interrupt Rating	
			Minimum	Maximum
2800203	—	1	5V <sub>AC</sub>	1mA(resistive)
2800204			5V <sub>DC</sub>	
Weight [kg / 1]			0.02	
Units per Package			10	

  
  

**Fuse Clips for 10mm Diameter Contacts**

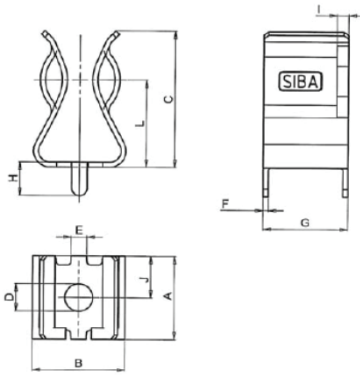

5806316

Dimensions [ in / mm]		
5806316		5806319
0.43 / 11.0	A	0.43 / 11.0
0.47 / 12.0	B	0.47 / 12.0
0.71 / 18.0	C	0.71 / 18.0
0.14 / 3.6	D	0.14 / 3.6
0.08 / 2.0	E	—
—	E <sub>1</sub>	0.08 / 2.0
—	E <sub>2</sub>	0.12 / 3.0
0.03 / 0.65	F	0.03 / 0.65
0.43 / 11.0	G	0.43 / 11.0
0.18 / 4.45	H	0.18 / 4.45
0.06 / 1.5	I	0.06 / 1.5
0.22 / 5.5	J	0.22 / 5.5
0.45 / 11.5	L	0.45 / 11.5

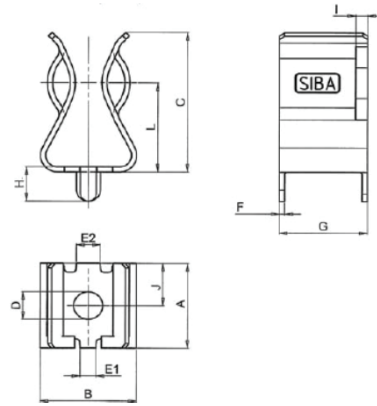

5806319





URPV

Accessories  
Fuse Clips

Fuse Clips for 10mm Diameter Contacts

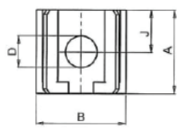
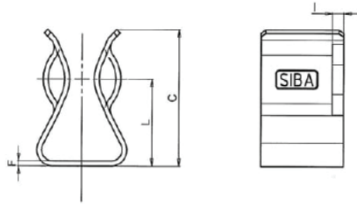

5806317

Dimensions [ in / mm]			
5806317		6301701	6101701.3
0.43 / 11.0	A	0.39 / 10.0	0.83 / 21.0
0.47 / 12.0	B	0.35 / 9.0	0.24 / 6.0
0.71 / 18.0	C	0.08 / 2.0	0.08 / 2.0
0.17 / 4.2	D	0.17 / 4.2	—
	D <sub>1</sub>	—	— / M5
	D <sub>2</sub>	—	— / M4
—	E	—	0.61 / 15.5
0.03 / 0.65	F	—	0.43 / 11.0
—	G	—	0.22 / 5.5
—	H	—	—
0.06 / 1.5	I	—	—
0.22 / 5.5	J	—	—
0.45 / 11.5	L	—	—

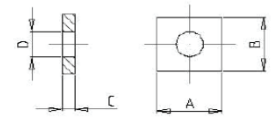

6301701

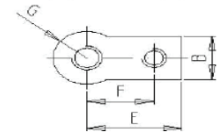
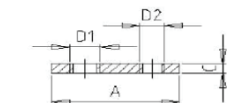

6101701.3

Fuse Clips for 14mm Diameter Contacts

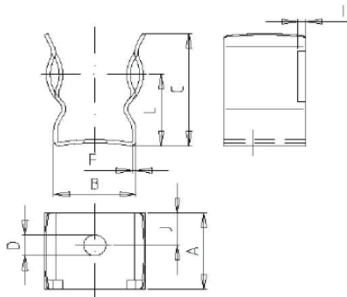

6100101.2

Dimensions [ in / mm]		
6100101.2		6301701
0.61 / 15.5	A	0.39 / 10.0
0.61 / 15.5	B	0.35 / 9.0
0.90 / 22.8	C	0.08 / 2.0
0.17 / 4.2	D	0.17 / 4.2
0.03 / 0.7	F	—
0.06 / 1.5	I	—
0.26 / 6.5	J	—
0.57 / 14.5	L	—

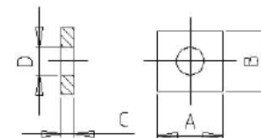

6301701

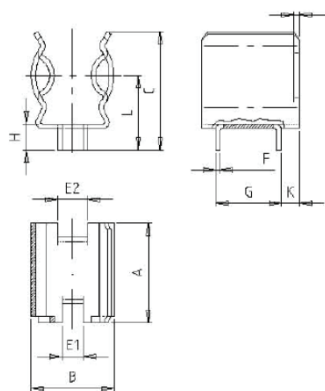

5805806

Dimensions [ in / mm]		
58 058 06		
0.63 / 16.0	A	
0.47 / 12.0	B	
0.61 / 15.5	C	
0.14 / 3.5	E <sub>1</sub>	
0.20 / 5.0	E <sub>2</sub>	
0.03 / 0.70	F	
0.42 / 10.7	G	
0.17 / 4.2	H	
0.04 / 1.0	I	
0.12 / 3.0	K	
0.33 / 8.5	L	

URPV

**Accessories - Insertion / Removal Tool**  
European NH Knife Blade Fuse System to 1600V<sub>AC</sub>

**NH1 - NH3 (a<sub>5</sub> = 120mm - 124mm)**



2203101 (Standard)

**Do Not Operate Under Load!**

2203102 (with Leather Sleeve)

**Do Not Operate Under Load!**

**European NH Knife Blade Fuse System to 690V<sub>AC</sub>**

**NH00 - NH3**

2200102 (Standard)

2200105 (with Leather Sleeve)

**NH4 & 4a**

2212001 (with Leather Sleeve)



**Do Not Operate Under Load!**